

**FLOORS 20 & 21 MULTI-TENANT TEST FIT
(OFFICE)**

29,080 RSF

Tenant A		Tenant B		Tenant C	
Office	19	Office	20	Office	13
Open Work Area	10	Open Work Area	18	Open Work Area	18
Assignable seats	29	Assignable seats	31	Assignable seats	31

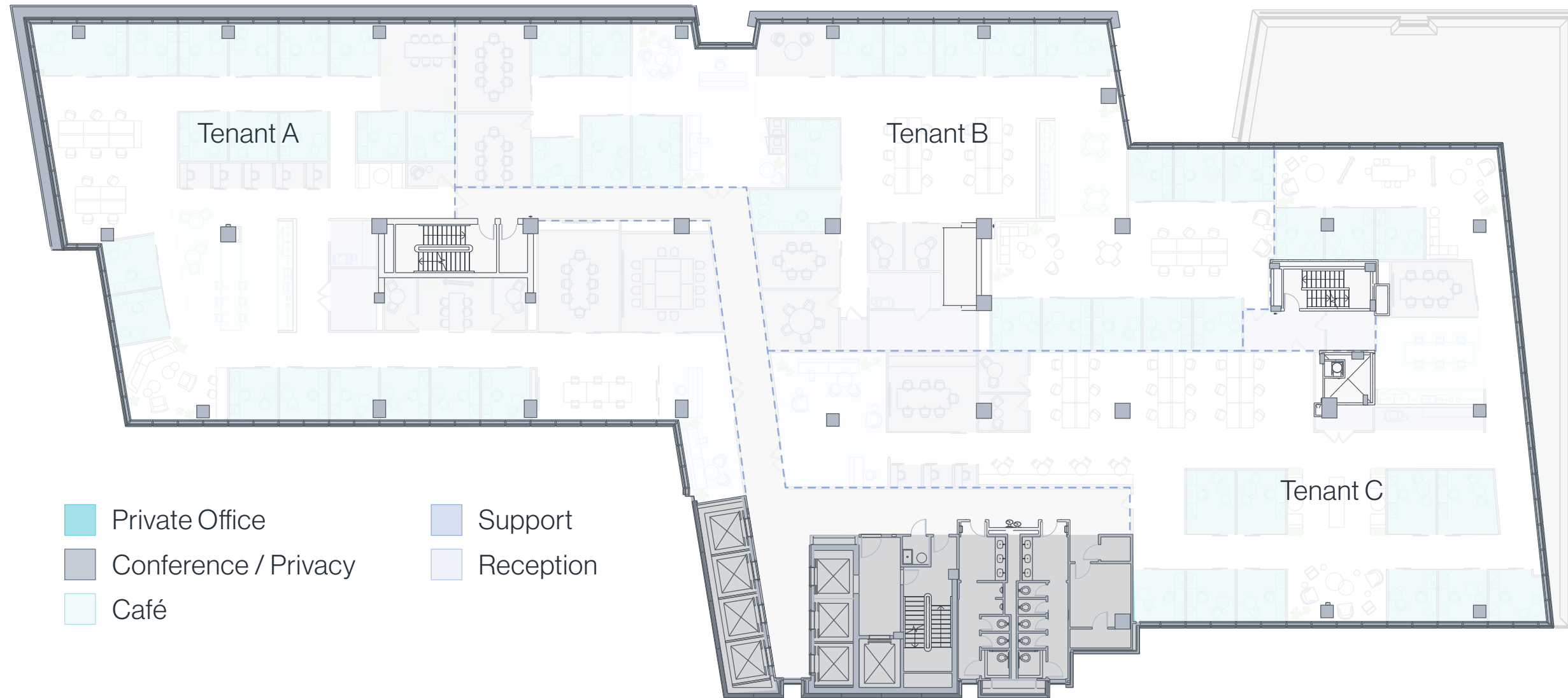

CONTACT US

7373 WISCONSIN AVENUE, BETHESDA, MD 20814

Keith Foery

301.896.9028
keith.foery@transwestern.com

Phil McCarthy

301.896.9011
keith.foery@transwestern.com

Mark Boyce

301.896.9090
keith.foery@transwestern.com

Karla Rivera

301.896.9016
keith.foery@transwestern.com

Chris Coccaro

301.896.9003
keith.foery@transwestern.com

