

**FLOORS 9-15 MULTI-TENANT TEST FIT  
(HYBRID)**

22,080 RSF

**Tenant A**

Office **14**  
Open Work Area **40**

Assignable seats **54**

**Tenant B**

Office **13**  
Open Work Area **37**

Assignable seats **50**

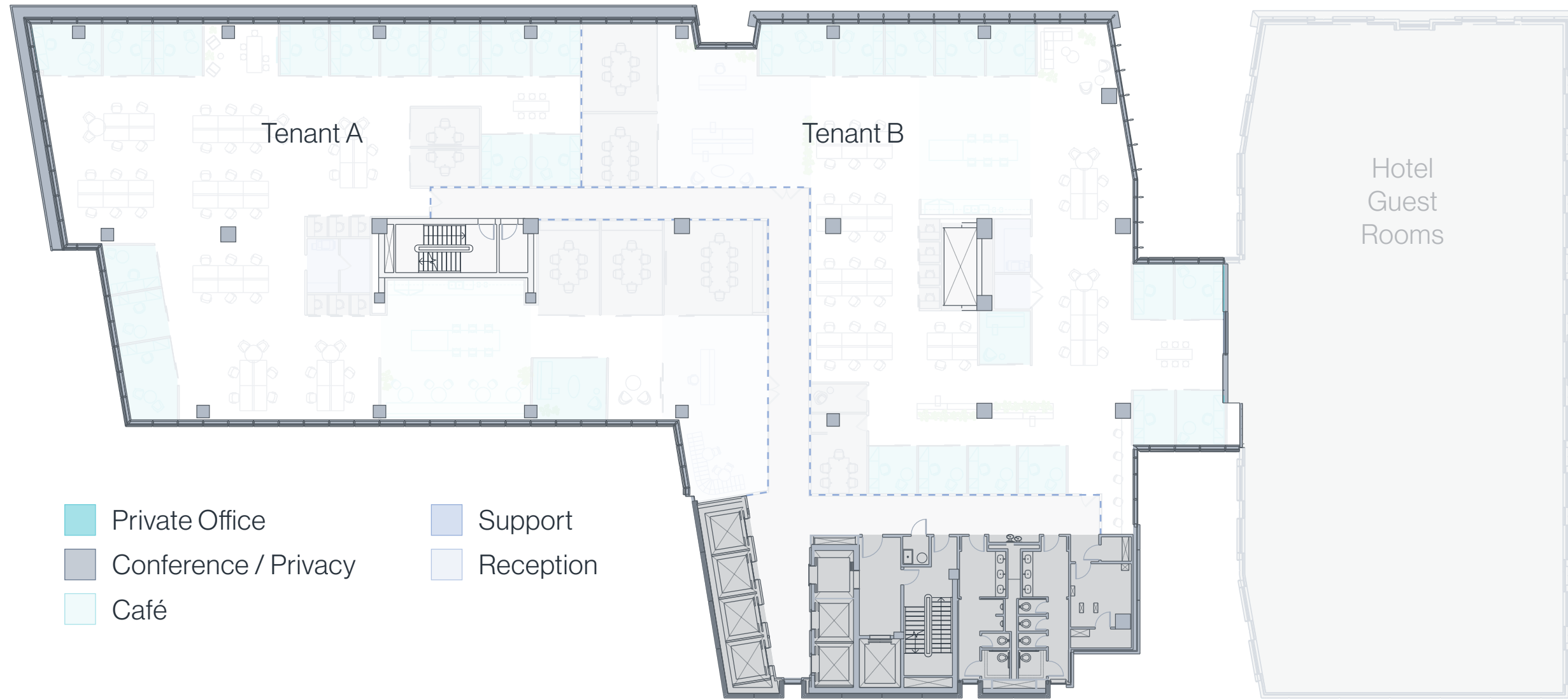

**CONTACT US**

**7373 WISCONSIN AVENUE, BETHESDA, MD 20814**

**Keith Foery**

301.896.9028  
keith.foery@  
transwestern.com

**Phil McCarthy**

301.896.9011  
keith.foery@  
transwestern.com

**Mark Boyce**

301.896.9090  
keith.foery@  
transwestern.com

**Karla Rivera**

301.896.9016  
keith.foery@  
transwestern.com

**Chris Coccaro**

301.896.9003  
keith.foery@  
transwestern.com

