

**FLOORS 9-15 MULTI-TENANT TEST FIT
(OFFICE)**

22,080 RSF

Tenant A

Office **23**
Open Work Area **18**

Assignable seats **41**

Tenant B

Office **18**
Open Work Area **19**

Assignable seats **37**

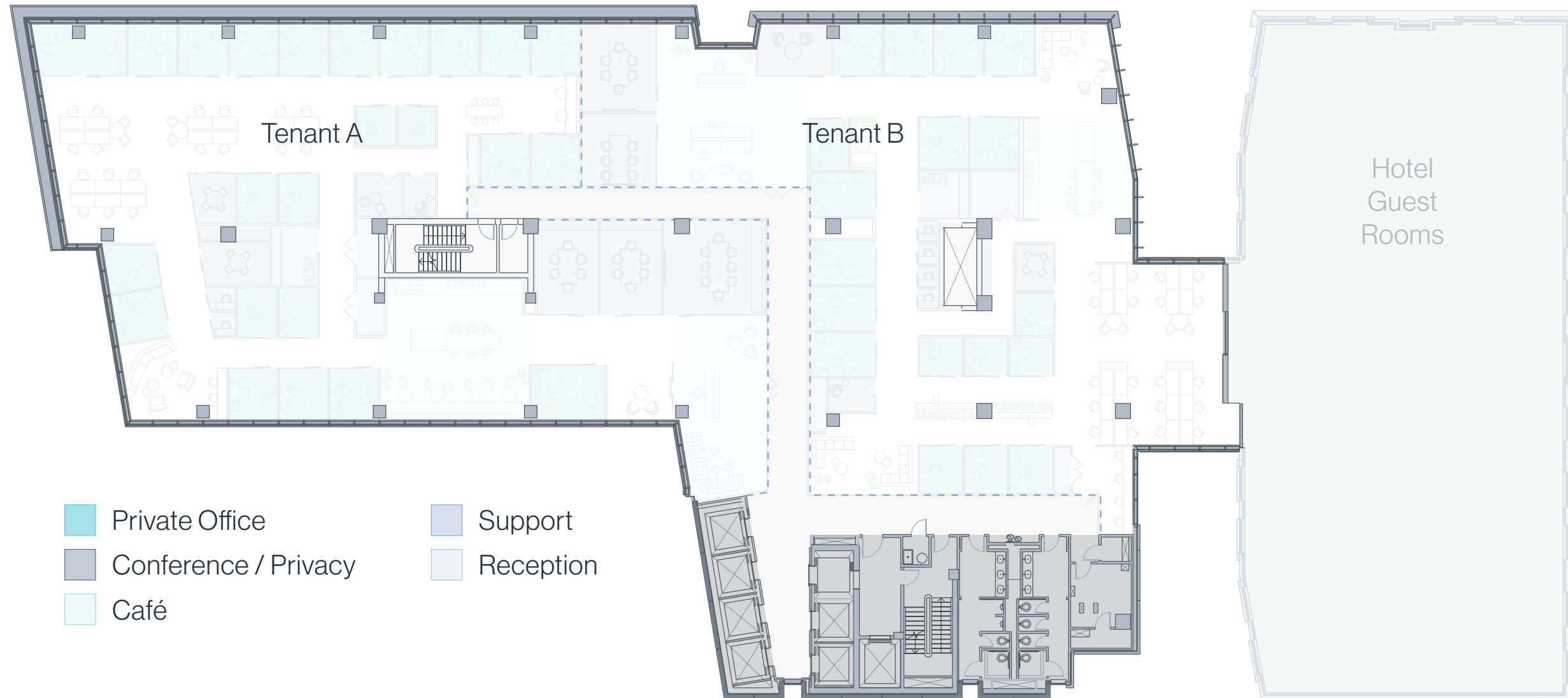

CONTACT US

7373 WISCONSIN AVENUE, BETHESDA, MD 20814

Keith Foery

301.896.9028
keith.foery@
transwestern.com

Phil McCarthy

301.896.9011
keith.foery@
transwestern.com

Mark Boyce

301.896.9090
keith.foery@
transwestern.com

Karla Rivera

301.896.9016
keith.foery@
transwestern.com

Chris Coccaro

301.896.9003
keith.foery@
transwestern.com

