

## GROUND FLOOR

### Double-height lobby

lounge seating and trophy finishes

### Attended reception desk

concierge service and 24/7 security

### Secure bike storage

on P1 level with complimentary repair station

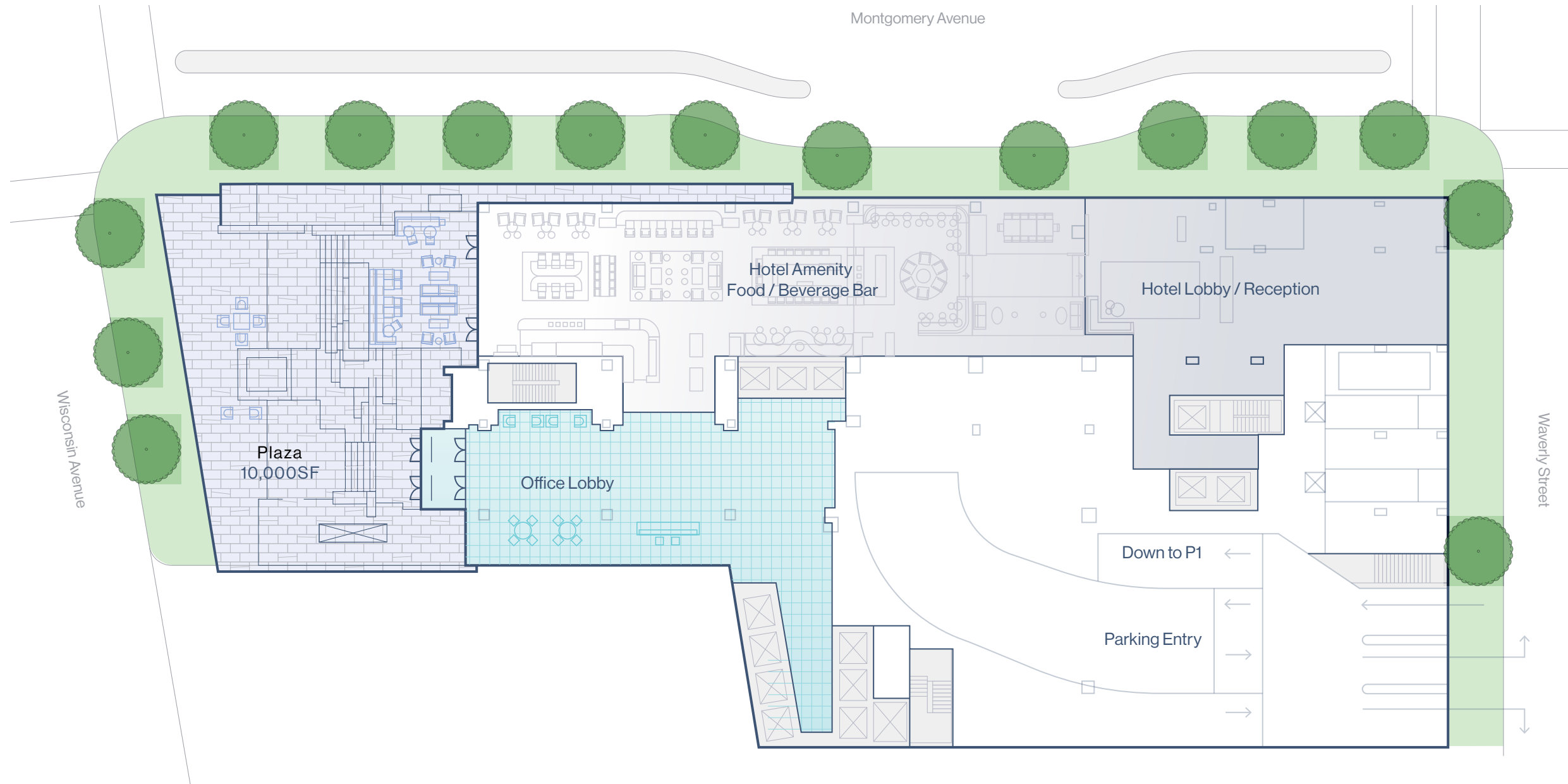

## CONTACT US

7373 WISCONSIN AVENUE, BETHESDA, MD 20814

Keith Foery

301.896.9028  
keith.foery@  
transwestern.com

Phil McCarthy

301.896.9011  
phil.mccarthy@  
transwestern.com

Mark Boyce

301.896.9090  
mark.boyce@  
transwestern.com

Karla Rivera

301.896.9016  
karla.rivera@  
transwestern.com

BEACON  
CAPITAL PARTNERS

STONEBRIDGE

TRANSWESTERN