

**FLOORS 20 & 21 MULTI-TENANT TEST FIT  
(HYBRID 1)**

29,080 RSF

<b>Tenant A</b>		<b>Tenant B</b>		<b>Tenant C</b>	
Office	11	Office	9	Office	8
Open Work Area	28	Open Work Area	36	Open Work Area	38
Assignable seats	39	Assignable seats	45	Assignable seats	46

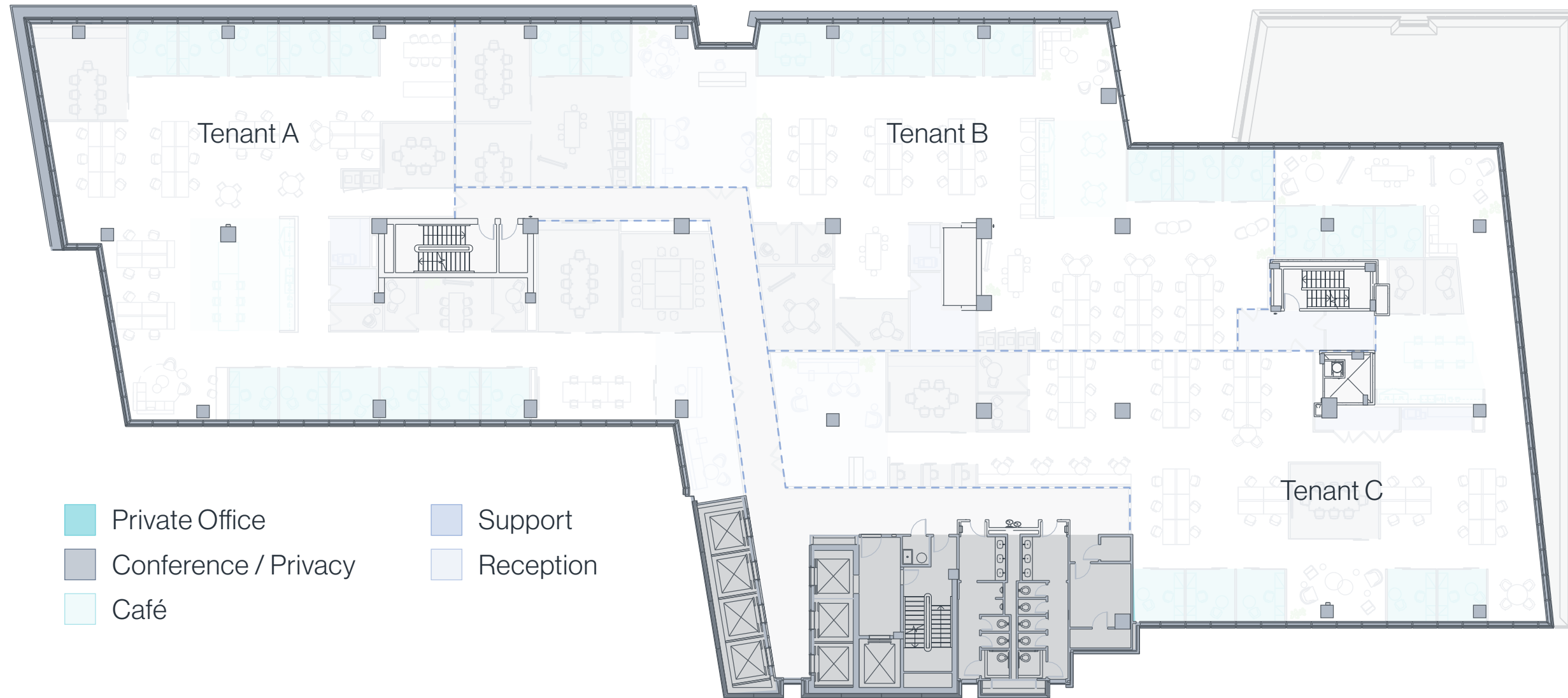

**CONTACT US**

7373 WISCONSIN AVENUE, BETHESDA, MD 20814

**Keith Foery**

301.896.9028  
keith.foery@transwestern.com

**Phil McCarthy**

301.896.9011  
phil.mccarthy@transwestern.com

**Mark Boyce**

301.896.9090  
mark.boyce@transwestern.com

**Karla Rivera**

301.896.9016  
karla.rivera@transwestern.com

