

**FLOOR 20 & 21 MULTI-TENANT TEST FIT  
(HYBRID 2)**

29,080 RSF

<b>Tenant A</b>		<b>Tenant B</b>		<b>Tenant C</b>	
Office	<b>10</b>	Office	<b>10</b>	Office	<b>9</b>
Open Work Area	<b>24</b>	Open Work Area	<b>53</b>	Open Work Area	<b>36</b>
Assignable seats	<b>34</b>	Assignable seats	<b>63</b>	Assignable seats	<b>45</b>

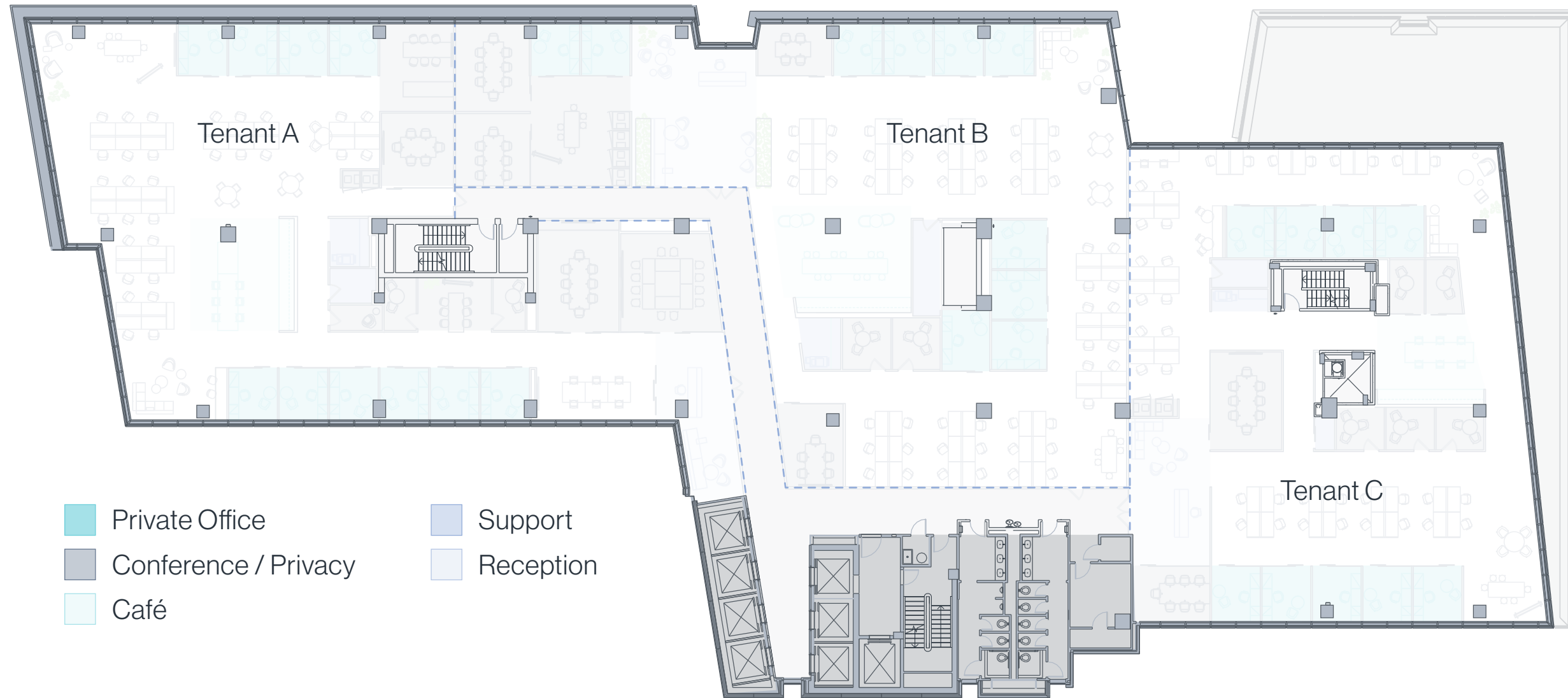

**CONTACT US**

**7373 WISCONSIN AVENUE, BETHESDA, MD 20814**

**Keith Foery**

301.896.9028  
keith.foery@  
transwestern.com

**Phil McCarthy**

301.896.9011  
phil.mccarthy@  
transwestern.com

**Mark Boyce**

301.896.9090  
mark.boyce@  
transwestern.com

**Karla Rivera**

301.896.9016  
karla.rivera@  
transwestern.com

