

**TYPICAL FLOORS 9-15 TEST FIT
(HYBRID)**

22,373^{RSF}

Private Office	18	Conference / Meeting	66
Open Work Area	71	Pantry	6
Assignable seats	89	Work Collab. / Lounge	80
		Phone Room	4

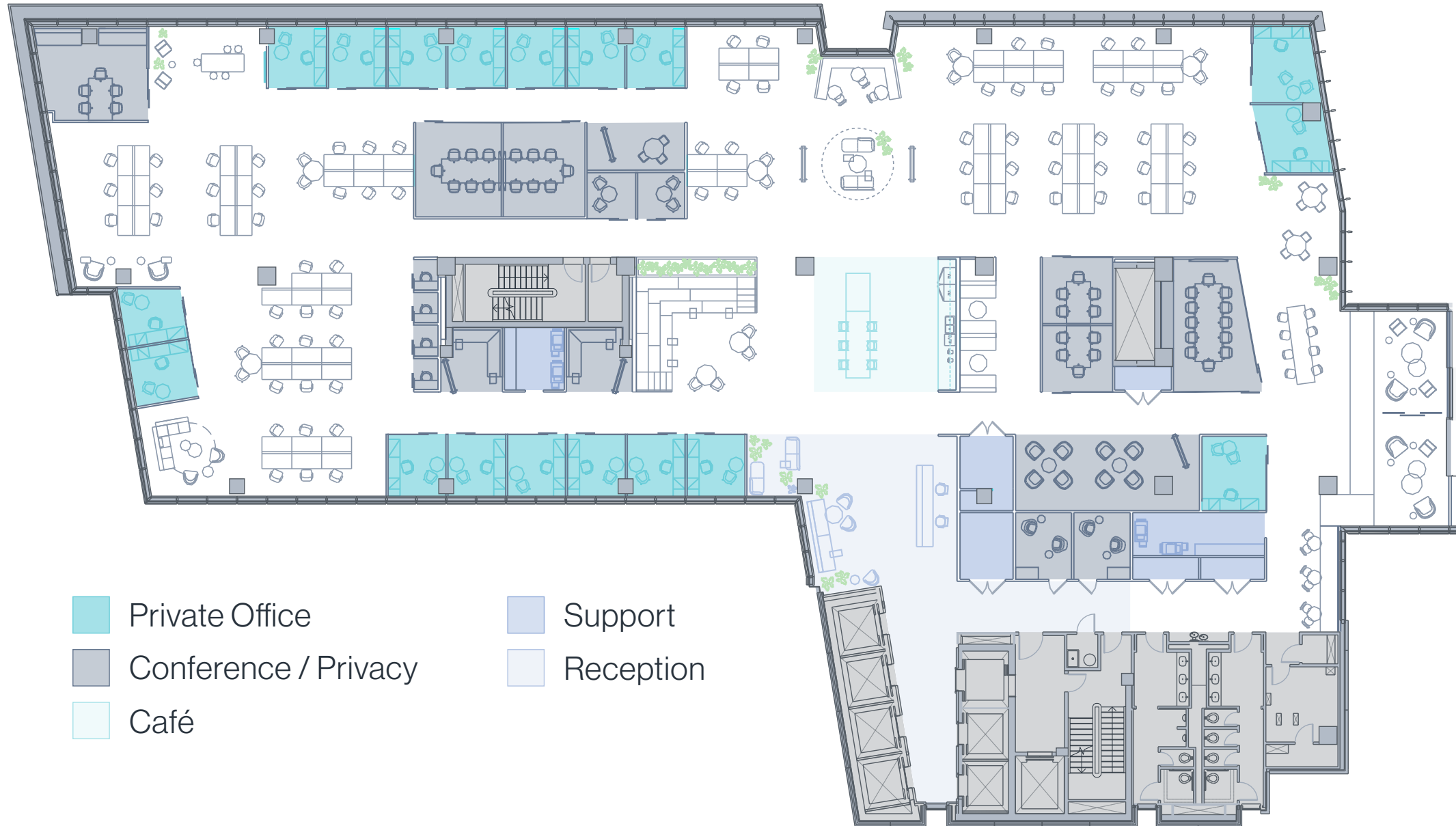

- Private Office
- Conference / Privacy
- Café
- Support
- Reception

CONTACT US

7373 WISCONSIN AVENUE, BETHESDA, MD 20814

Keith Foery

301.896.9028
keith.foery@transwestern.com

Phil McCarthy

301.896.9011
phil.mccarthy@transwestern.com

Mark Boyce

301.896.9090
mark.boyce@transwestern.com

Karla Rivera

301.896.9016
karla.rivera@transwestern.com

