

**TYPICAL FLOORS 10 - 14 (TEST FIT)
HYBRID**

23,128^{RSF}

Private Office	18	Conference / Meeting	66
Open Work Area	71	Pantry	6
Assignable seats	89	Work Collab. / Lounge	80
		Phone Room	4

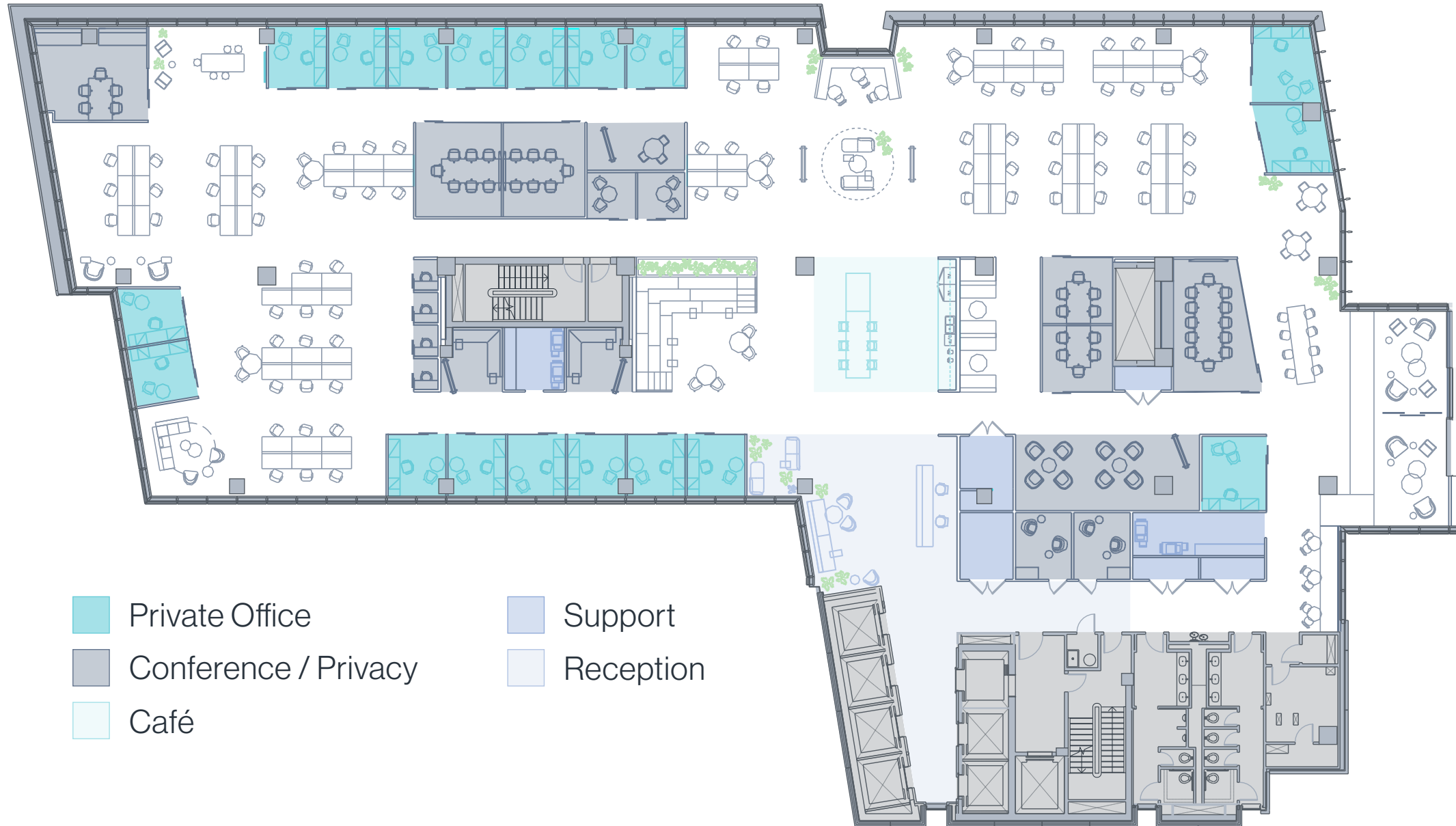

- Private Office
- Support
- Conference / Privacy
- Reception
- Café

CONTACT US

7373 WISCONSIN AVENUE, BETHESDA, MD 20814

Keith Foery
301.896.9028
keith.foery@transwestern.com

Phil McCarthy
301.896.9011
phil.mccarthy@transwestern.com

Mark Boyce
301.896.9090
mark.boyce@transwestern.com

Karla Rivera
301.896.9016
karla.rivera@transwestern.com

